

Supports tightening up to **600 N·m!**

Large Tracer Arm

- Position Detection
- Reaction Cancellation
- Poka-yoke System

EH2-LTA1113

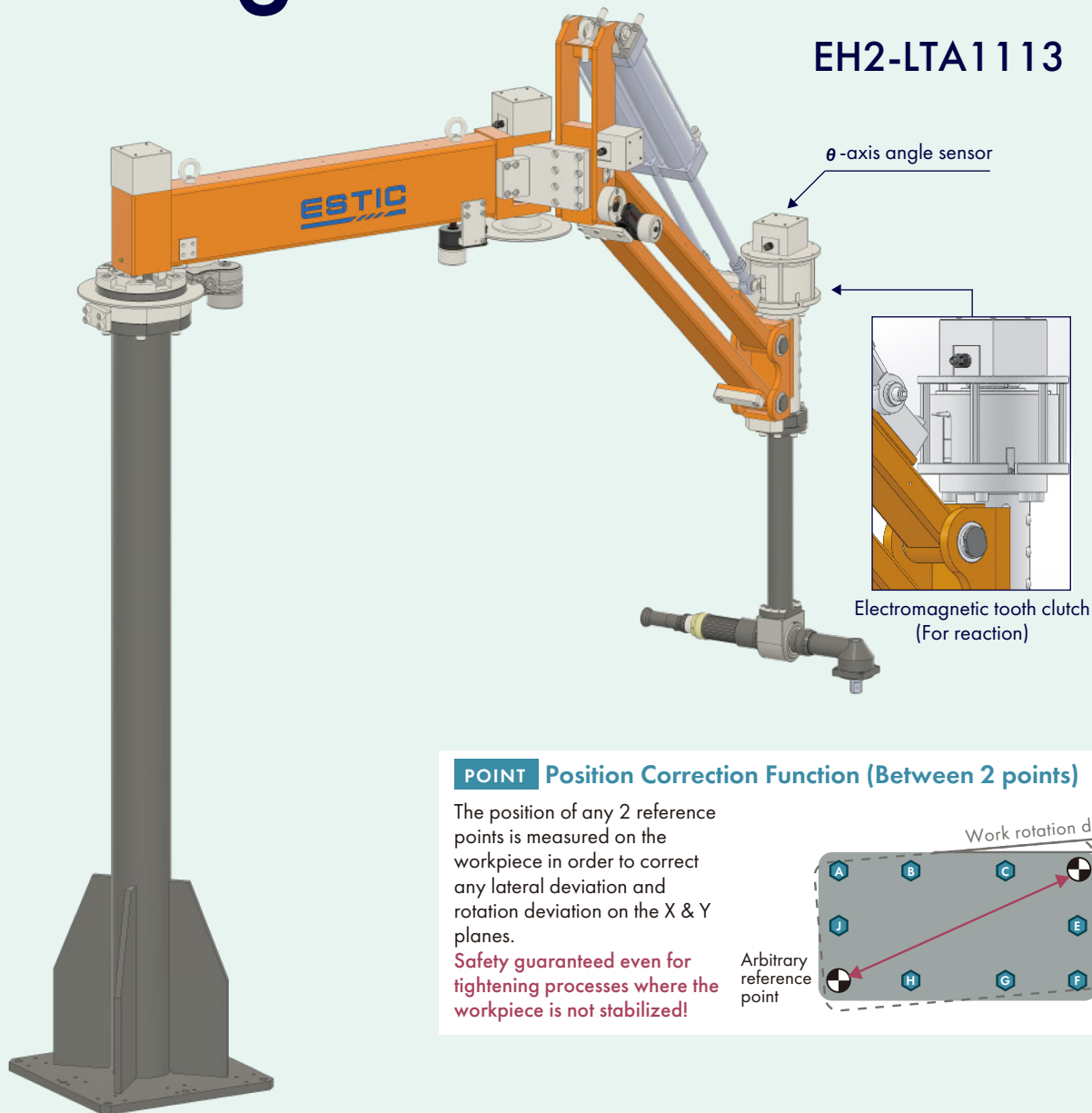

POINT Position Correction Function (Between 2 points)

The position of any 2 reference points is measured on the workpiece in order to correct any lateral deviation and rotation deviation on the X & Y planes.

Safety guaranteed even for tightening processes where the workpiece is not stabilized!

The diagram shows a rectangular workpiece with reference points A through F. Two 'Arbitrary reference points' are marked with circles. A red arrow indicates 'Work rotation deviation' between these points.

Compatible with various tightening directions!

Horizontal / Vertical
(Straight / Right Angle Tool)

Offset Position
(Right Angle Tool)

Multi-spindle
θ-axis rotation

Multi-spindle
Lateral movement

Specifications

Model	EH2-LTA1113-L / EH2-LTA1113-R
Maximum applicable torque	600 N·m
Arm length	1100 × 1300 mm
Recommended work area	2000 × 1500 × 1000 mm
Arm lift length (st)	1466 mm
Load capacity	30 kg (At 0.4 MPa)
Air supply	0.4 ~ 0.6 MPa
Arm body weight	210 kg
Repeat position detection accuracy	±3 mm
Input sensor	Resolver 4 points (x, y, z, θ-axis)
Number of registerable workpieces	99 types (63 positions can be registered per work)
Controllers	Handy 2000 Lite plus EH2-HT45-000*** Handy 2000 Touch EH2-HT50-000***

Dimensions

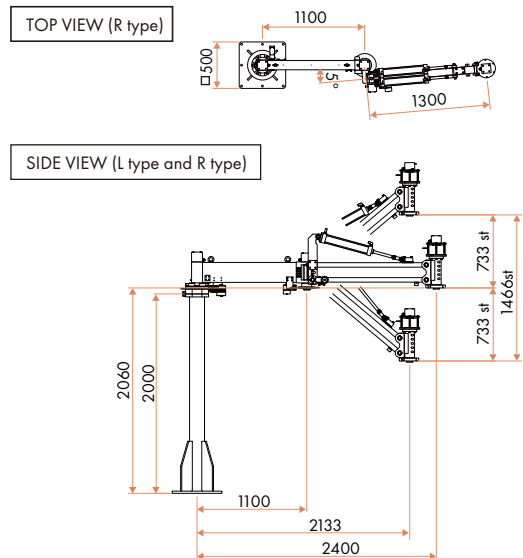

Range of Movement

EH2-LTA-1113-R

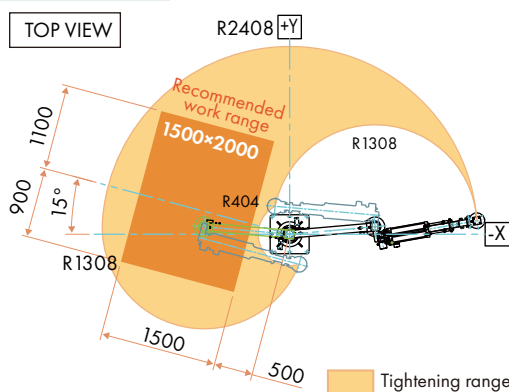

EH2-LTA-1113-L

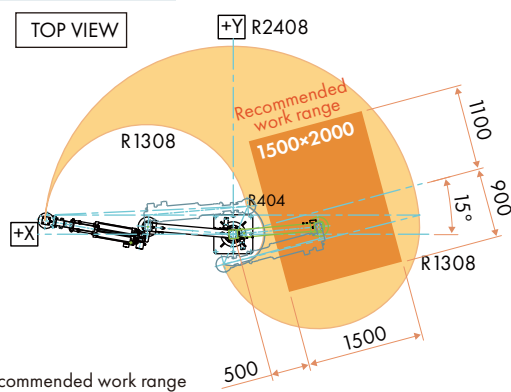

Connection System Diagram

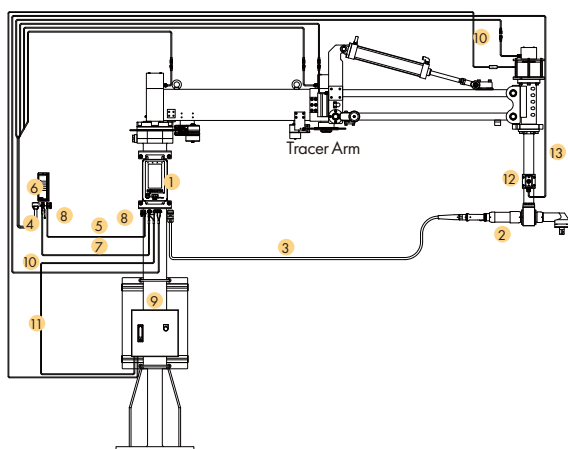

Name	Model
1 Handy 2000 Series control unit	EH2-HT45-000*** / EH2-HT50-000***
2 Applicable tool model	EH2-R***-*
3 Tool cable	EH2-CVS**-SS
4 Resolver cable	Made-to-order product
5 NET cable	EH2-CVNK-***
6 Trace control unit	EH2-TCU2-N
7 TCU power cable	EH2-CVDC-030
8 NET termination resistor	EH2-CNST (2 pieces required)
9 Tooth clutch power BOX	Made-to-order product
10 Tooth clutch power cable	Made-to-order product
11 Control signal cable	Made-to-order product
12 Parking brake switch	Made-to-order product
13 Switch cable	Made-to-order product



ESTIC CORPORATION

1-2-16 Togodori, Moriguchi-city, Osaka, 570-0041 Japan

● CAD data can be downloaded from our website.

<https://www.estic-global.com/member>



JP : www.estic.co.jp
 EN : www.estic-global.com/
 CN : www.cn.estic-global.com

YouTube www.youtube.com/user/EsticCorporation
LinkedIn www.linkedin.com/company/estic-corporation