

Handheld Nutrunner Handy 2000 Series

High-Torque Tightening with Collaborative Robots



POINT 1 Maximum 140N·m Tightening

By using patented "ESTIC PULSE" technology to achieve minimal reaction from tightening, up to 140N·m tightening with collaborative robots is made possible. Without sacrificing the detection of fastening failures or traceability, ESTIC PULSE Technology enables automated high torque tightening.



YouTube Video

POINT 2 UR + Certified

ESTIC's nutrunner is a certified UR peripheral or UR + (plus) product that can be used with Universal Robots.

ESTIC URCap application for operating UR robots enables intuitive robot programming for tightening joints.



More info

What is Pulse Tightening Technology, "ESTIC PULSE"?

ESTIC has acquired patented technology to reduce the reaction torque towards the operator during tightening/torquing process. By capturing torque data every 1/2,000 second and controlling the next tightening force, a safe and highly accurate tightening is possible. By using ESTIC PULSE technology-equipped handheld tools, physical strain on the operator can be significantly reduced, improving ergonomics in a production line. ESTIC Handheld tool is a ergonomic tightening solution both for humans and robots.



YouTube Video



Simple setup with easy cable management

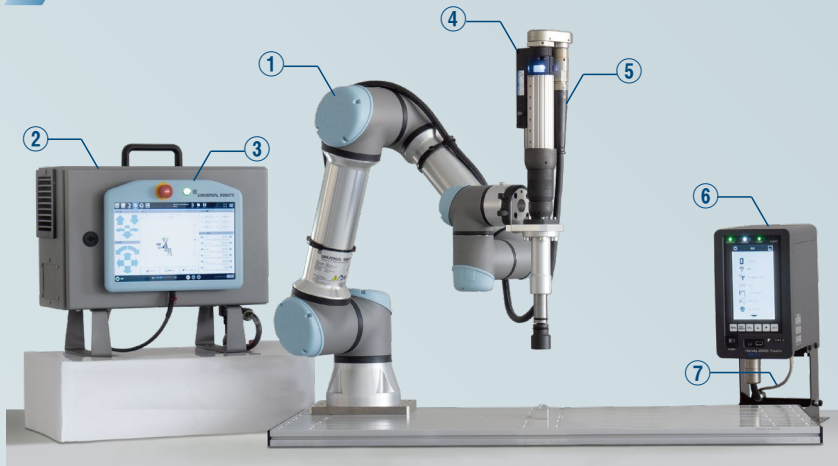

◆ Universal Robots System

- ① Collaborative Robot
- ② Control Box
- ③ Teaching Pendant

◆ ESTIC Handheld Nutrunner System

- ④ Tool Unit
- ⑤ Tool Cable
- ⑥ Control Unit *

* Compatible with Handy 2000 Lite plus / Handy 2000 Touch / Handy 2000 Micro

◆ Modbus TCP Communication

- ⑦ Ethernet Cable

Matrix of UR Robots and ESTIC Tools

		ESTIC Handheld Nutrunner *					
Torque Range		≤5 N·m	25 N·m	45 N·m	70 N·m	100 N·m	140 N·m
Type		Straight			Right Angle		
Universal Robots	UR3e	●					
	UR5e	●	●	●			
	UR10e	●	●	●	●		
	UR16e	●	●	●	●	●	●

* Please contact us for the tool models not listed above.

Starter kit makes it easier !

Starter kit including URCaps app, a mounting bracket and floating spindle is available for easy implementation.

You can quickly pair UR Robot and ESTIC system with this starter kit.

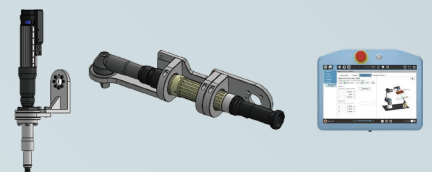

ESTIC offers professional tightening solution specialized in high-precision fastening.

We have strived to provide high accuracy tightening solution mainly for the automotive industry. Recently, our focus is to promote the integrated solution of industrial robots and our DC nutrunners. Please contact us for any concerns regarding tightening / fastening.



ESTIC CORPORATION
1-2-16 Togodori, Moriguchi-city,
Osaka, 570-0041 Japan



JP : www.estic.co.jp
EN : www.estic-global.com/
CN : www.cn.estic-global.com/



www.youtube.com/user/EsticCorporation



www.linkedin.com/company/estic-corporation